

Ultraframe[®]

Transforming light and space



Glassroof

By Ultraframe

Gable

Installation Guide

Version 1 | JUNE 2013

GABLE INSTALLATION

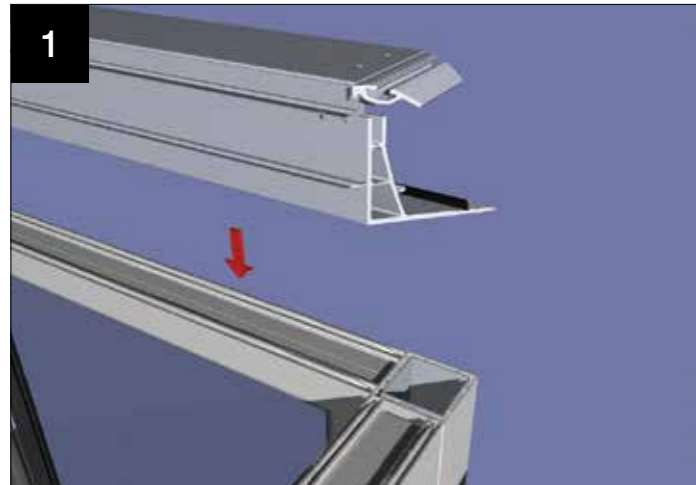

1 Trial fit the gable beam and the eaves beam ensuring the inside face is flush with the inside face of the window/door frames. Remove, then apply a continuous bead of silicone to both the front and rear edges of the window/door frames.

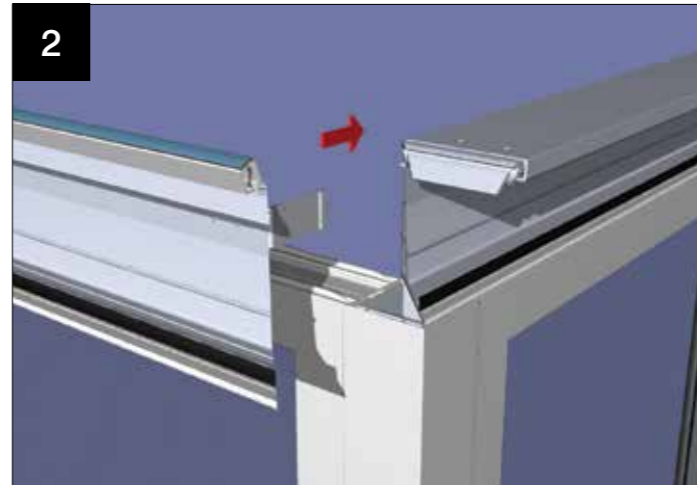

2 Fit the under gutter trim to each section of eaves beam and gable beam, position the beams and slide the corner cleats (already attached to the eaves beam) into the gable beam. Drill through the holes already in the gable beam into the gable beam. Drill through the holes already in the gable beam into the cleats and secure with the screws supplied.

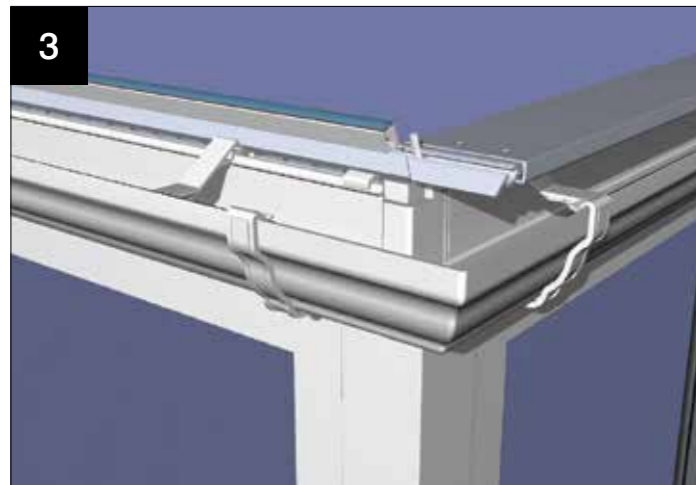

3 To secure the gable beam (see Vic Fixing Kit page 11), then at this stage the guttering is installed. First attach the gutter brackets to the gable/eaves beam. Fit the 90 degree external gutter corners to the gable beam length of gutter. The brackets are at maximum 750mm centres and 200mm from each corner.

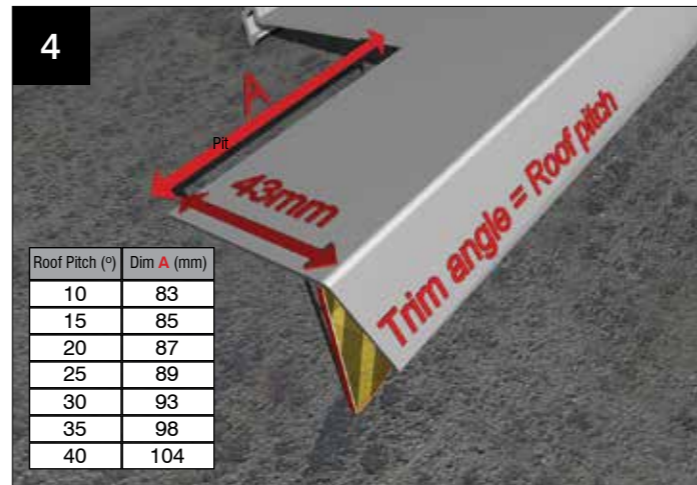

4 With the guttering in place, trim the gable beam top cladding. The cladding is supplied over length and cut to suit the roof pitch (see table).

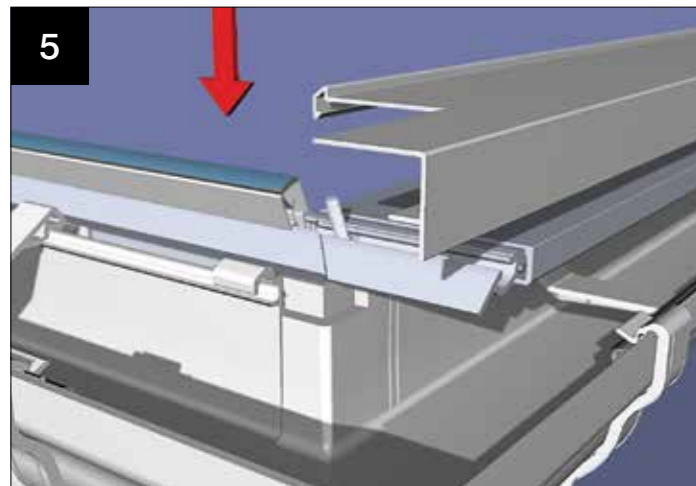

5 Next attach the notched gable beam top cladding on to the head of the gable beam.

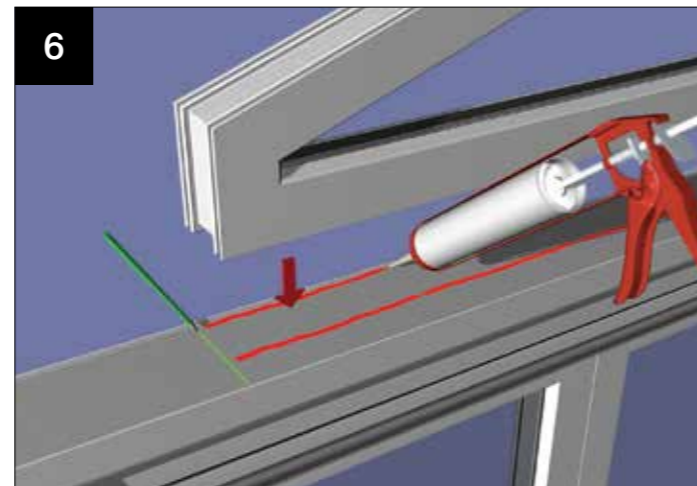

6 Position the gable window frame central to the gable beam, and mark the position. Remove the frame and again run two beads of silicone along the head of the gable beam top cladding (the width of the window frame only). Replace the frame centrally and back against the upstand of the gable beam top cladding. Fix securely through the frame into the head of the gable beam with self tapping screws (not supplied).

GABLE INSTALLATION

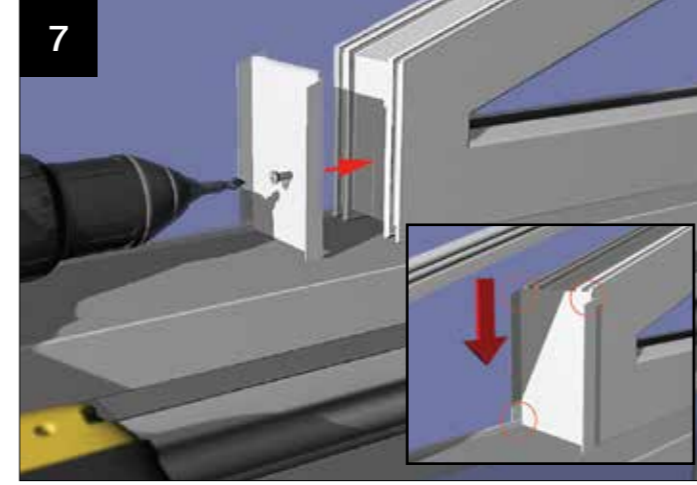

7 Mark and cut the gable infill end cap. Notch inner bottom edge to allow the end cap to sit flush and tight to the gable window frame. Trim top edge to suit pitch of roof and gable frame furring top cap which should be placed into position for marketing purposes. First silicone and then screw the end cap to the gable frame.

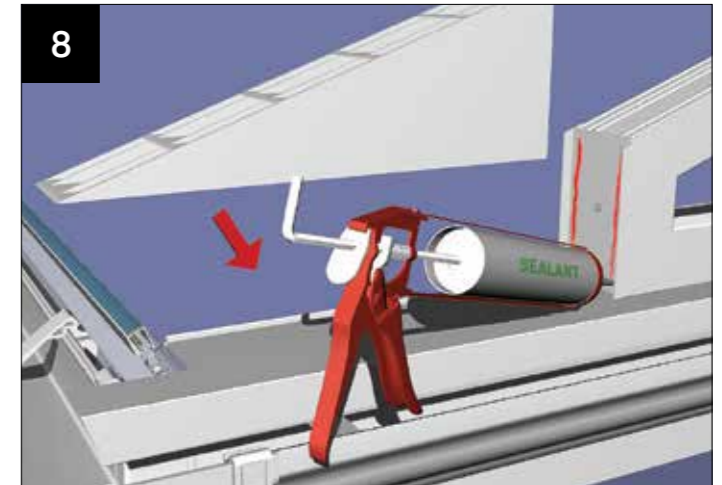

8 Trial fit the gable infill wedge. Remove, run two beads of silicone and place back in position, tight up against the infill wedge end cap. **NOTE: it will be necessary for non standard pitches to trim the infill wedge to suit the pitch, maintaining the 135mm height dimensions.**

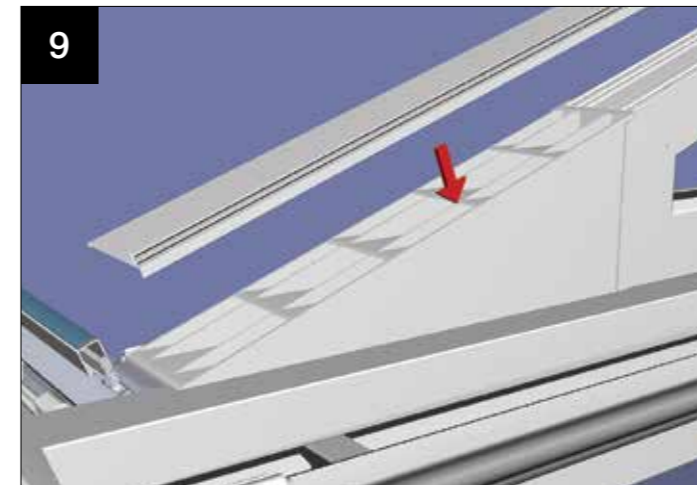

9 Position the gable frame furring top cap along the gable frame and over the infill wedge. The bottom edge of the gable frame furring top cap is cut to finish flush with the lower edge of the infill wedge and the end of the gable beam. The top edge is cut vertically to suit the roof pitch. Silicone in position.

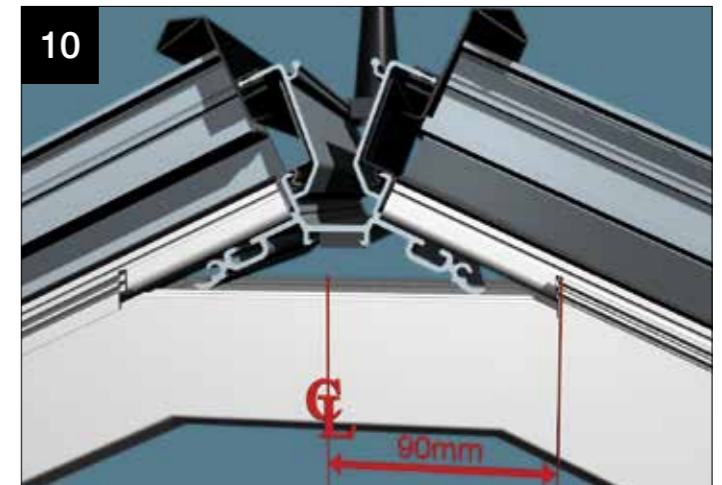

10 Place and support the ridge ensuring the ridge is central to the gable frame. Place the starter bar onto the furring top cap and secure to the ridge and eaves beam. Securely fix the starter bars to the gable window frame. Fit and glaze the roof in the normal manner. **NOTE: Ensure the gable frame is vertically plumb.**

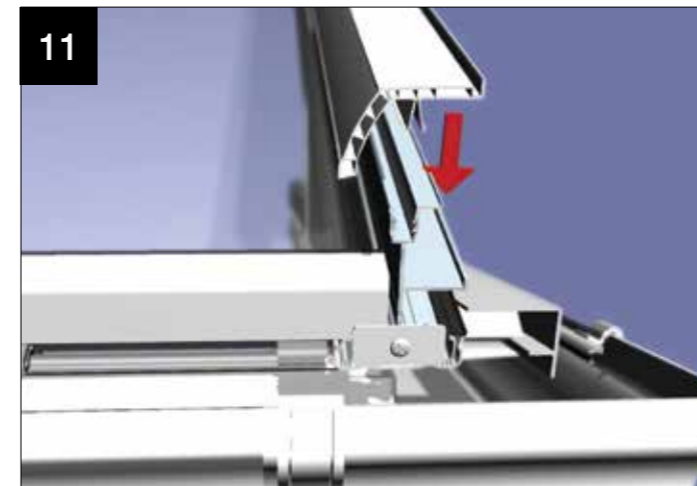

11 Fit the starter bar top capping in position.

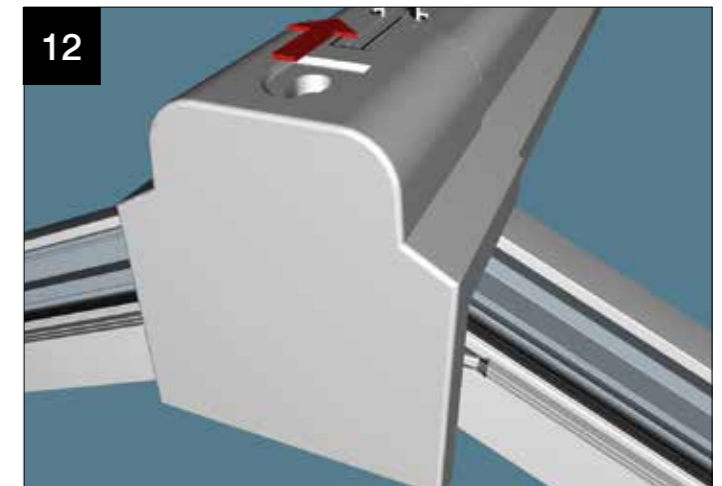

12 Fit the gable ridge end cap as per the Victorian installation guide (ie to suit frame thickness)

GABLE INSTALLATION

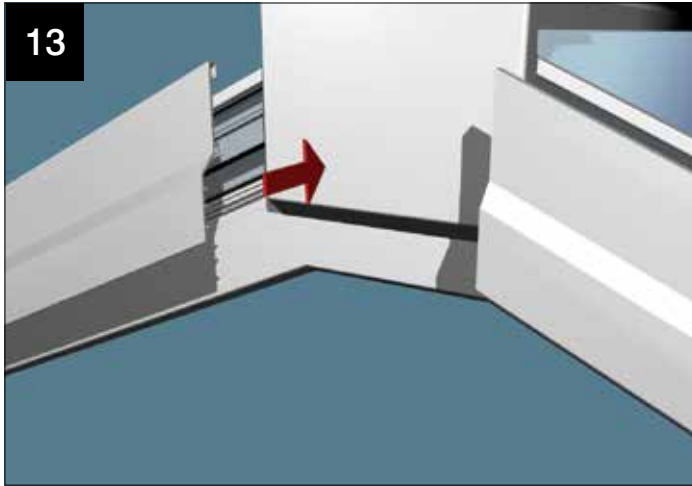

13 Offer the lean to cloaking trim up to the side of the gable ridge end cap and scribe to suit the roof pitch – push into place against the end cap.

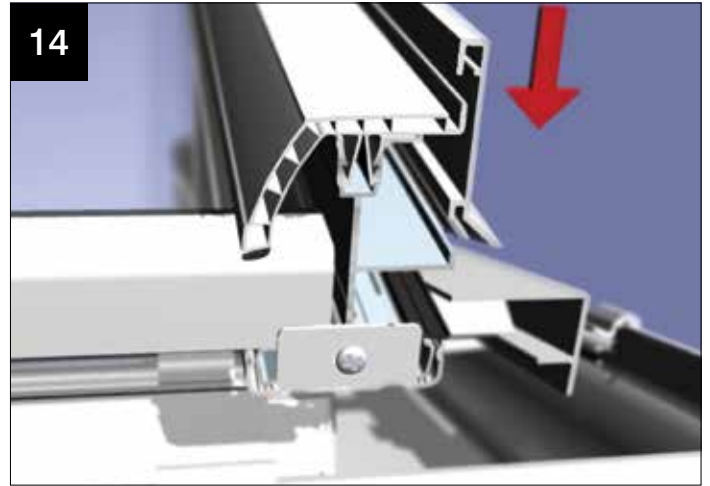

14 The overall length of the lean to cloaking trim is to the end of the starter bar. Cut in-line with the end of the starter bar. The tapered cut along the lower edge runs parallel with and along the gable beam top cladding. See table. All intermediate pitches require scribing.

Roof Pitch (°)	Dim C (mm)	Dim D (mm)
10	133	23
15	115	31
20	105	38
25	99	46
30	94	54
35	89	62
40	85	71

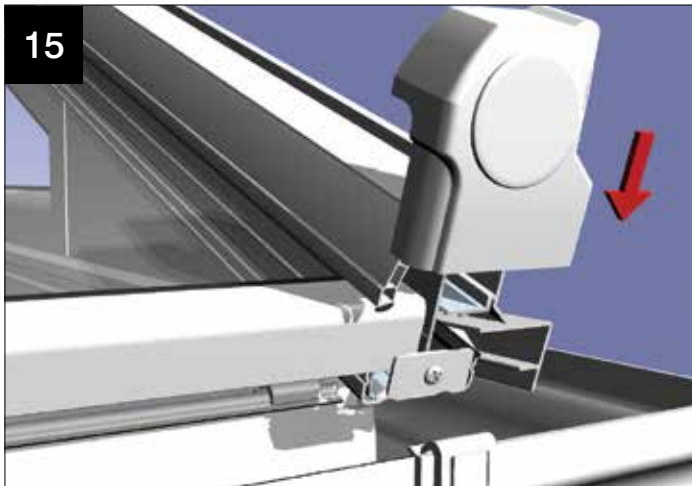

15 Finally fit the starter bar end cap.

QUANTAL

www.quantal.co.uk

Ultraframe[®]
Transforming light and space

www.ultraframe.co.uk