

# Ultraroof Beam Bracketry

Ultraroof Continuous Improvement Notice

Following customer feedback your Ultraroof eaves beam has been updated to include additional brackets on the internal corners to support the mitred joint. If you receive these brackets with your order please fit as shown below.

**NOTE: These brackets not specified on variable pitch roofs.**

## 15° to 19° Roof Pitch



WPBBF090  
U380 90° INTERNAL CLEAT STRAP  
1 PER MITRE



WPBCS 135  
U380 135° INTERNAL CLEAT SMALL  
1 PER MITRE



WPBCS 150  
U380 150° INTERNAL CLEAT SMALL  
1 PER MITRE

## 20° to 29° Roof Pitch



WPBBF 090  
U380 90° INTERNAL CLEAT STRAP  
1 PER MITRE

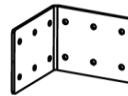

WPBCM 090  
U380 90° INTERNAL CLEAT MEDIUM  
1 PER MITRE



WPBCM 135  
U380 135° INTERNAL CLEAT MEDIUM  
1 PER MITRE



WPBCM 150  
U380 150° INTERNAL CLEAT MEDIUM  
1 PER MITRE

## 30° to 40° Roof Pitch



WPBBF 090  
U380 90° INTERNAL CLEAT STRAP  
1 PER MITRE

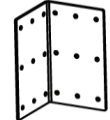

WPBCL090  
U380 90° INTERNAL CLEAT LARGE  
1 PER MITRE

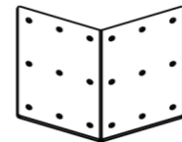

WPBCL 135  
U380 135° INTERNAL CLEAT LARGE  
1 PER MITRE

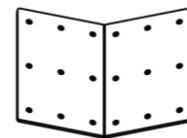

WPBCL 150  
U380 150° INTERNAL CLEAT LARGE  
1 PER MITRE

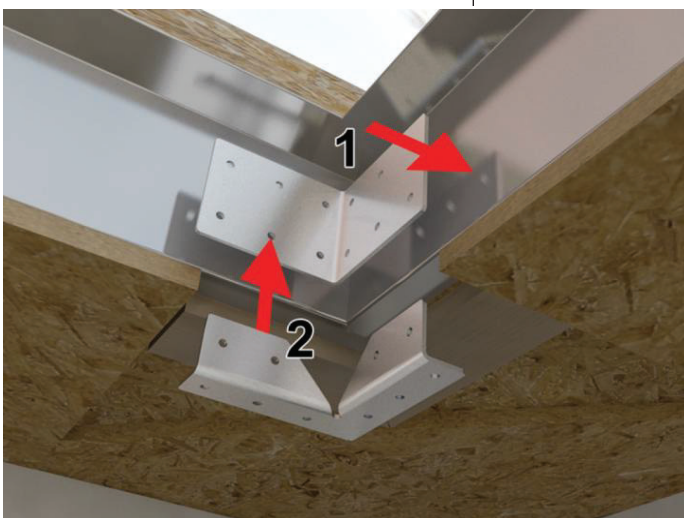

Offer the supplied brackets to the eaves beam as shown and screw fix into position with the 13mm long fixings provided (CHA006). Note that cleat strap WPBBF090 is only required on 90° mitres.

# IMPROVED HIP ASSEMBLY - EQUAL PITCHES



1  
The Ultrarroof hip design has been updated; extending the steel and aluminium components over the beam mitre for an improved structural connection.



2  
In equal pitch situations the beam setout shelf remains the same as current.



3  
The hip assembly features a square cut beam overhang and in-line hip wings.



4  
When in position, the hip should sit on the beam panel shelves as shown and be fixed as described in the main installation guide.



5  
Fix the hip down into the beam through x 4 pre-drilled holes using WPCS020 (supplied).

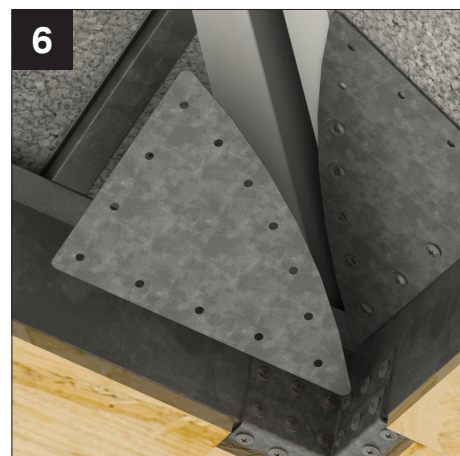

6  
Position and fix the internal hip retaining plates using 18 x CHAA 006 screws provided.  
**NOTE; THESE PLATES ARE NOT REQUIRED ON VICTORIAN HIPS.**



# IMPROVED HIP ASSEMBLY - VARIABLE PITCHES



**1**  
In variable pitch situations the beam setout shelf is asymmetric, with the longest side relating to the beam with the steepest pitch – see location plan.



**2**  
The assembled varying pitch beams will look something like the example shown.



**3**  
The hip assembly features a notched beam overhang and offset hip wings. The notch should be oriented towards the beam with the steeper pitch.

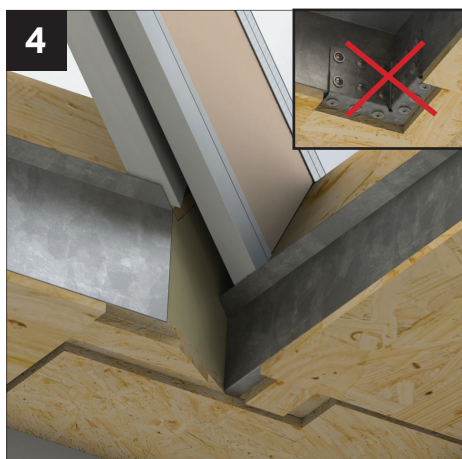

**4**  
When in position, the offset hip wings should sit on the beam panel shelves as shown and be fixed as described in the main installation guide. **NOTE: INTERNAL BEAM CORNER CLEATS NOT SUPPLIED IN VARIABLE PITCH SITUATIONS.**



**5**  
Fix the hip down into the beam through x 4 pre-drilled holes using WPCS020 (supplied).

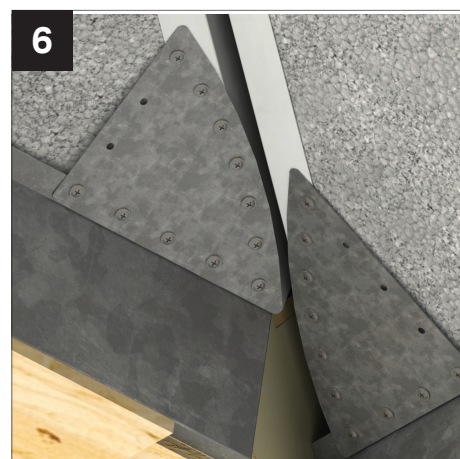

**6**  
Position and fix the internal hip retaining plates using 18 x CHAA 006 screws provided. **NOTE: THE ORIENTATION OF THE PLATES CAN BE CHANGED TO ALLOW FOR OPTIMUM FIXING AS SHOWN.**

[www.ultraframetrade.co.uk](http://www.ultraframetrade.co.uk)

Ultraframe<sup>®</sup>

Job No.: 4086 03/19 V2 WPBIG002

It is Ultraframe's policy to continually seek to improve its products, processes and services, and we reserve the right to change specifications without prior notice. Ultraframe is a trading name of Ultraframe (UK) Limited.